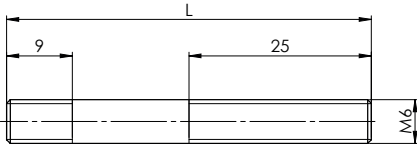
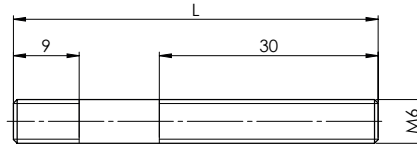

**Fixations pour les empilages verticaux**
**NG10**
**TIRANT M6xL**

**TIRANT M6xL K8**

Hauteur de serrage	Dimensions	No. d'article
73 ... 89	M6x106	224.3000
82 ... 96	M6x115	224.3002
96 ... 112	M6x129	224.3003
108 ... 124	M6x141	224.3004
120 ... 136	M6x153	224.3006
128 ... 144	M6x161	224.3007
140 ... 156	M6x173	224.3008
149 ... 165	M6x182	224.3009
159 ... 175	M6x192	224.3010
175 ... 191	M6x205	224.3011
187 ... 203	M6x220	224.3012
196 ... 212	M6x229	224.3013
204 ... 220	M6x237	224.3014
213 ... 229	M6x246	224.3019
225 ... 241	M6x258	224.3015
234 ... 250	M6x267	224.3016
252 ... 268	M6x285	224.3020
292 ... 308	M6x325	224.3018
360 ... 378	M6x393	224.3021

Hauteur de serrage	Dimensions	No. d'article
68 ... 89	M6x106	224.3063
77 ... 96	M6x115	224.3050
91 ... 112	M6x129	224.3051
103 ... 124	M6x141	224.3052
115 ... 136	M6x153	224.3053
135 ... 156	M6x173	224.3054
144 ... 165	M6x182	224.3055
154 ... 175	M6x192	224.3056
170 ... 191	M6x205	224.3057
182 ... 203	M6x220	224.3058
191 ... 212	M6x229	224.3060
199 ... 220	M6x237	224.3059
220 ... 241	M6x258	224.3062
247 ... 268	M6x285	224.3061
259 ... 280	M6x297	224.3066
355 ... 378	M6x393	224.3065

Matériel: ETG100  
 Surface: bruni

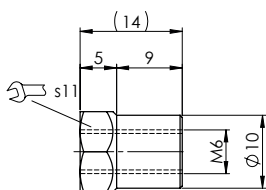
Matériel: Acier inoxydable 1.4057

**ECROU A COL M6**
**No. d'article 154.7400**

Couple de serrage: 9.5 Nm

Pour A.4x10 (1.2-71)

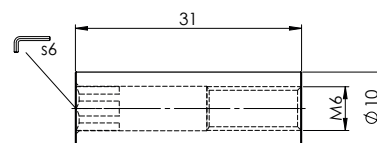
**ECROU A COL M6**
**No. d'article 154.0602**

Couple de serrage: 9.5 Nm

Pour WDMFA10 (1.2-76)